

INVENTORY THOMAS PARSON

23^s / 1639

Husbandman of Albury.

In the Hall 1 Cupboard, 1 table, 1 bench, 1 form

3 brass kettles, 1 iron pot, 1 brass postratt, pot hooks & pot hangers
1 spit, 1 gridiron, 2 buckets

In the Kitchin 3 firkins, 1 tub, 2 keves, 1 cupboard

1 fryns pan, 1 butter churn, other milke vessels

Wool

2 beds, 2 bedstaddles, 8 sheets, 5 blankets, 2 coverlets
1 piece white cloth.

In the house rye, 1 bag of hops, 1 chest, 1 tub

Bacon, Cheese press, Lumber & tools for husbandry.

In the Barn Corn. In the gate dung

Hop poles, beans, garden fruits.

Sheep, lambs, 1 cow, 1 mare, 2 hogs

Upon the land wheat, rye, oats, French wheat

Debts owed to deceased. £ 4-4-4.

£ 47. 1. 00

Thomas Skare, husbandman, Waveroh

Thomas Tickner, yeoman, Waveroh

William Parson, weaver, Albury

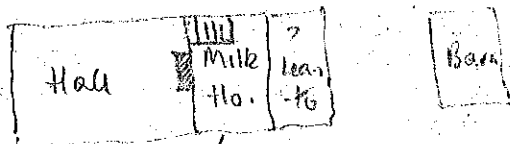

PARSON Thomas
[PARSONS]

Husbandman
23rd May 1639

ALBURY
[ALDBURY]

An Inventarye of all and Singullar the Reddye monnye Goodes Chattelles and Deptes of Thomas Parson of Aldburye in the Countye of Surrey husbandman late deceased as upon the 23^{the} daye of Maye in the yeare of our Lord god 1639 it was valued and Appraised by Thomas Tickner of Womershe in the Countye of Surrey yeoman William Parson of Aldburye in the Countye of Surrey weaver and Thomas Steare of Womershe in the Countye afforesayd husbandman

In priuis The monnye in his purse and his wearinge Apparell	} 1 ^l - 10 ^s - 00 ^d
Item in the hall one Cutchboard one table one benche one forme	} 00 - 10 ^s - 00 ^d
Item three brasse Kettelles one Iron pott one brasse postnett pott hookes and pott hangers one spitt one greedron and two buckettes	} 00 - 10 ^s - 00 ^d
Item in the milkhouse three virkins one tub and two kiers and a Cutchbord	} 1 ^l - 2 ^s - 00 ^d
Item for a fryinge pan and a butter Cherne and other milke vesselles	} 00 - 6 ^s - 00 ^d
Item for wooll	00 - 13 ^s - 4 ^d
Item for two beds and two bedsteddes eight sheets five blanckets and two Coverlets	} 2 ^l - 16 ^s - 8 ^d
Item one peice of white Clothe	1 ^l - 00 - 00
Item Rye in the house and one bag of hops one Chest and a tub	} 1 ^l - 11 - 4
Item for bacon	1 ^l - 00 - 00
Item for a Cheese presse with other lumber and tooles for husbandrye	} 00 - 4 - 00
Item Corne in the barne and dunge in the gate	5 - 10 - 00
Item hop tooles beanes and garden fruiles	00 - 10 ^s - 00 ^d
Item for sheep and lambes	8 - 10 - 00
Item for a Cowe and a mare and two hoges	5 - 10 - 00
Item for wheate and Rye upon the land	8 - 00 - 00
Item for oates upon the land and french wheat	3 - 13 - 4
Item awnige to the deceased by severall parties	4 - 4 - 4
Summe	<u>47 - 1 - 00</u> ✓

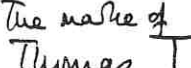
The marke of Thomas  Tickner
The marke of Thomas  Steare William Parson